

Installation Manual Presto / Presto AS



230V/50HZ T5



1. Gauges and mounting holes

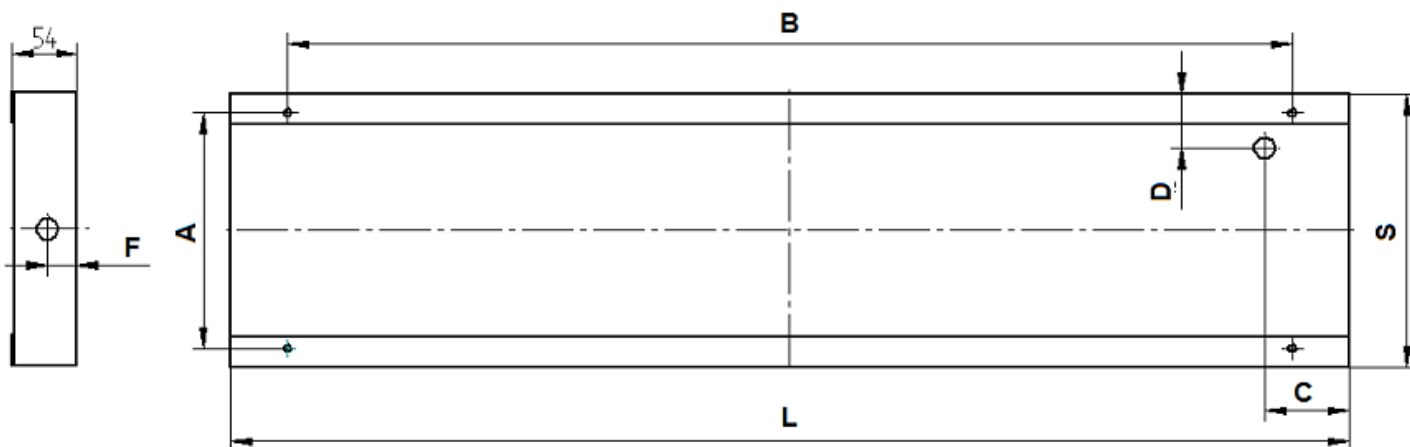

Presto 2x

	A	B	C	D	F	L	S	H
2 x 14W/24W	196	540	70	45	25	630	228	50
2 x 21W/39W	196	836	70	45	25	930	228	50
2 x 28W/54W	196	1136	70	45	25	1230	228	50
2 x 35W/49W/80W	196	1436	70	45	25	1530	228	50

Presto 1x

	A	B	C	D	F	L	S	H
1 x 14W/24W	118	540	70	40	25	630	152	50
1 x 21W/39W	118	836	70	40	25	930	152	50
1x 28W/54W	118	1136	70	40	25	1230	152	50
1 x 35W/49W/80W	118	1436	70	40	25	1530	152	50

2. Assembly

- a) put out carefully fixture from packaging and put In safety place
- b) using gloves take out louver or lampshade from the fixture
- c) Screw the electric and mechanic suspensions to the ceiling according to drawing. Screw in 4 tensions of line on the back of the fixture. Unscrew external nut lightly, put in line until obtaining optimum level of suspension and screw nut on. Putting line deeper cause fixture lifting. In order to lower fixture loose nut and press on - line will pull out.



- d) power connection

- push cables through cover gasket
- connect cables according to signs at power cube

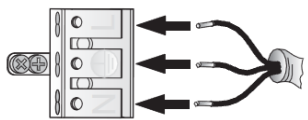

- e) fluorescent lamp mounting

- put fluorescent lamp in the fixture , lightly tightening put in lamp-socket and clasps
- rotate fluorescent lamp 90°
- install louvers

- f) put on the grounding cable on the louver

- g) put louver or lampshade inside the fixture



3. Important warnings:

Do not install the fixtures in areas without an exchange of air.
 The manufacturer cannot be considered liable for any damages deriving from improper, wrong and unreasonable use of the fitting.
 Luminaries may be installed by qualified personnel only.
 Any manipulation inside the luminar when power supply is on causes the risk of electric shock.
 Manufacturer is not responsible for any flaws caused by a void using this manual.
 Manufacturer reserves a right to change the construction of the product.



The European Directive 2002/96/EC on waste electrical and electronic equipment, requires that electric and electronic devices must be disposed of in the normal household waste. The crossed out wheeled bin is reproduced in order to remember obligations towards separately collection. For correct disposal, please use authorized waste disposal facilities or returned to the distributor at the date a new lighting fitting is purchased. Lamps, if disposed together with the lighting fitting, shall not be broken up since they contain substances which are highly polluting for the environment. Unauthorized disposal of the foregoing waste material is punishable by law.

