

Assembly Instruction

KARDO

KARDO



IP20



EL



230V/50HZ

1. Dimensions

Power [W]	Weight(kg)	Weight * (kg)
1x35/70/150	1,7	1,85
2x35/70/150	2,45	2,75
3x35/70/150	3,5	3,95
1x35-100	1,6	1,75
2x35-100	2,2	2,5
3x35-100	3,1	3,55
1x12 (LED)	1,7	1,85
2x12 (LED)	2,45	2,75
3x12 (LED)	3,5	3,95

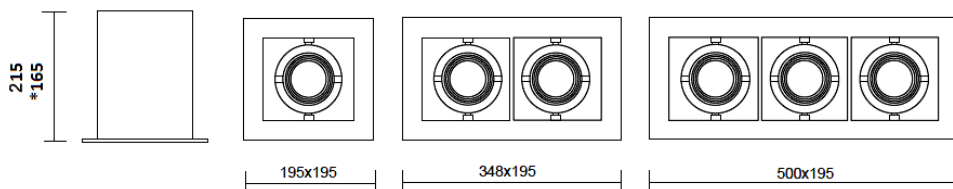

* Special version, power supply placed into separate additional housing

2. Power connection

- remove carefully fixture from packaging and put in safety place (table or floor),
- remove the housing of the power cube
- cut out the hole in the ceiling according to the table given on the right,
- take the power cable through the hole in the power cube's housing,
- connect cables according to scheme given on the power cube,
- screw on the housing to the power cube

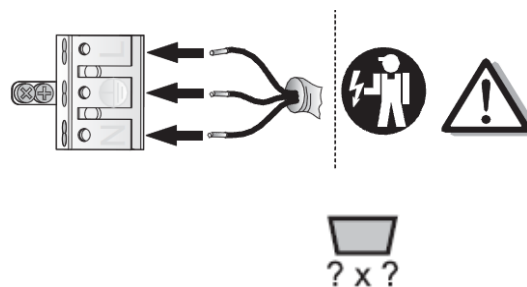

1x...	175x170
2x...	312x170
3x...	484x170

3. Ceiling assembly

- put the fixture into ceiling
- put and screw the assembling handles into the sides of the fixture

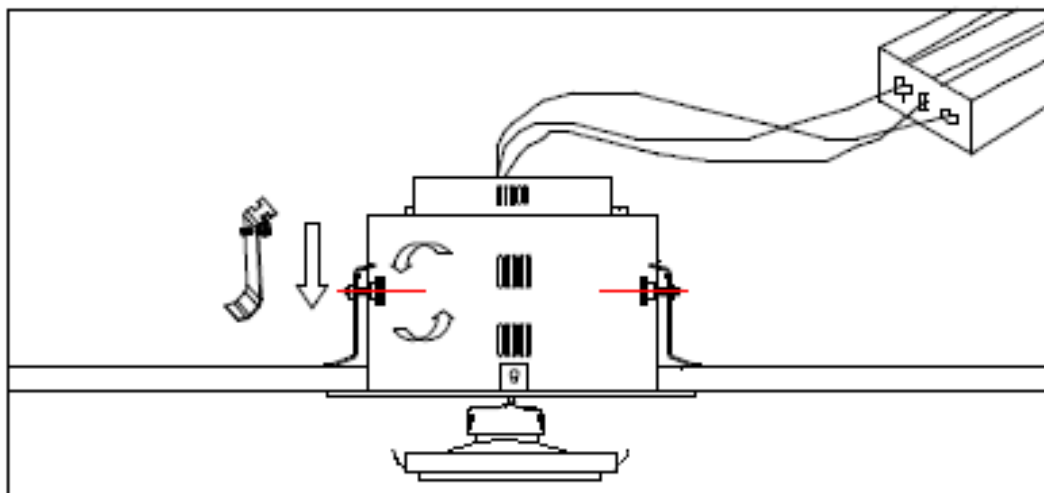

4. Assembling of light source

- i) using gloves, gently take off the ring from the housing,
- j) put the lighting source inside the ring,
- k) connect the power to the light source
- l) again assembly the ring into the housing:
 - rotate the ring's handle by an angle of 120°
 - press one metal clip into handle,
 - put and press second metal clip into the ring's handle,
 - turn the handle of ring to the previous angle

1) 2)

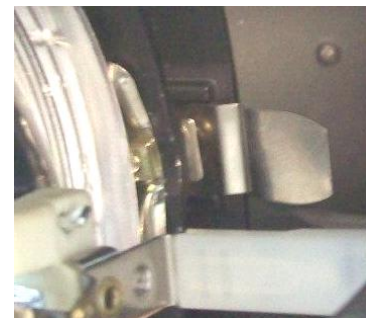

3) 4)



5. Important warnings:

- Do not install the fixtures in areas without an exchange of air.
- The manufacturer cannot be considered liable for any damages deriving from improper, wrong and unreasonable use of the fitting.
- Luminaries may be installed by qualified personnel only.
- Any manipulation inside the luminary when power supply is on causes the risk of electric shock.
- Manufacturer is not responsible for any flaws resulting from not complying with recommendations included in this instruction manual.
- Manufacturer reserves a right to change the construction of the product.



The European Directive 2002/96/EC on waste electrical and electronic equipment, requires that electric and electronic devices must be disposed of in the normal household waste. The crossed out wheeled bin is reproduced in order to remember obligations towards separately collection. For correct disposal, please use authorized waste disposal facilities or returned to the distributor at the date a new lighting fitting is purchased. Lamps, if disposed together with the lighting fitting, shall not be broken up since they contain substances which are highly polluting for the environment. Unauthorized disposal of the foregoing waste material is punishable by law. More details of directive available at: <http://www.gios.gov.pl>

