

Assembly instruction  
**Latte**

**LATTE**

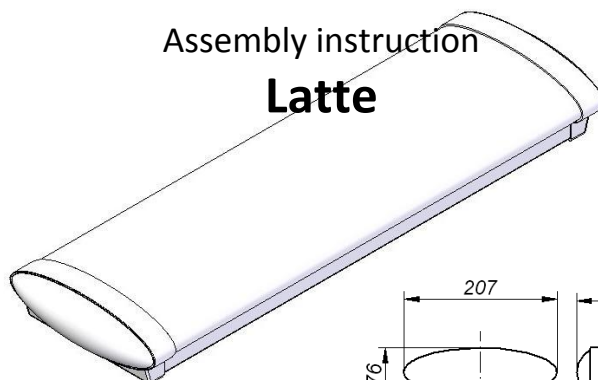
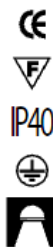

**230V/50HZ T8, T5**

**1. Sizes**

Moc	A	L	Waga EVG	Waga VVG
1x18/14/24	480	683	1,3 kg	1,5 kg
1x36/28/54	710	1293	2,3 kg	2,7 kg
1x58/35/49/80	910	1593	2,8 kg	3,3 kg
2x18/14/24	480	683	1,4 kg	1,7 kg
2x36/28/54	710	1293	2,4 kg	3,2 kg
2x58/35/49/80	910	1593	2,9 kg	3,8 kg

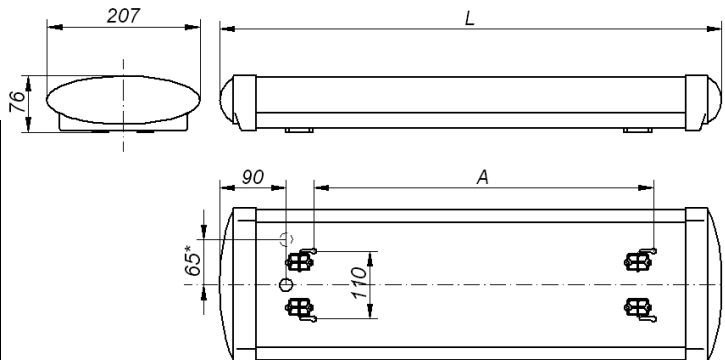

65\* – 1x versions

**2. Assembly**

- remove carefully fixture from packaging and put in safety and stable place (table or floor)
- using gloves remove diffuser
- power connection
  - put power cable through the hole in base of frame
  - connect cables according to signs at power cube
- assembly fixture to the ceiling:
  - fixture is fixed to the ceiling with four screws according to the diameter drawing on the first page
- fluorescent lamp mounting
  - put fluorescent lamp in the fixture
  - rotate fluorescent lamp 90°
- assembly the diffuser to the fixture and center it under the end caps

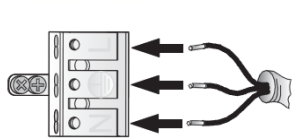

**3. Important warnings:**

- the manufacturer cannot be considered liable for any damages deriving from improper, wrong and unreasonable use of the fitting.
- luminaries may be installed by qualified personnel only.
- any manipulation inside the luminaire when power supply is on causes the risk of electric shock.
- manufacturer is not responsible for any flaws caused by avoid using this manual.
- manufacturer reserves a right to change the construction of the product.



The European Directive 2002/96/EC on waste electrical and electronic equipment, requires that electric and electronic devices must be disposed of in the normal household waste. The crossed out wheeled bin is reproduced in order to remember obligations towards separately collection. For correct disposal, please use authorized waste disposal facilities or returned to the distributor at the date a new lighting fitting is purchased. Lamps, if disposed together with the lighting fitting, shall not be broken up since they contain substances which are highly polluting for the environment. Unauthorized disposal of the foregoing waste material is punishable by law. More details of directive available at: <http://www.gios.gov.pl>

