

Installation manual
Torino IP



TORINO IP65



IP65



230V/50HZ T5, T8, TL

1. Dimensions and weight

Power	A	B	C	Weight (kg)
2x18W	95	314	616	5kg
4x18W	95	616	616	8kg
2x36W	95	314	1226	9kg
3x36W TL	95	616	616	8kg

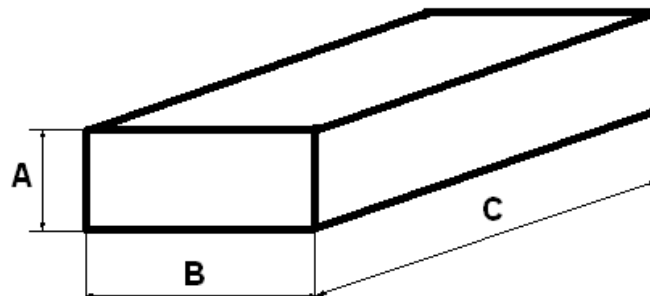

2. Assembly

- carefully take luminaire out of the box and place it on a stable surface (table or floor)
- open the luminaire with screwdriver
- power connection
 - place cover gasket in the hole of luminaire
 - push cables through cover gasket
 - connect cables according to signs at power cube
- ceiling suspension mounting:
 - luminaire mounted to ceiling with four holes of 7mm diameter

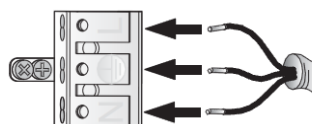

Power	A	B	C	D	E
2x18W	130	410	63	157	92
4x18W	430	410	68	308	93
2x36W	130	1020	390	157	92
3x36W TL	493	493	150	218	62

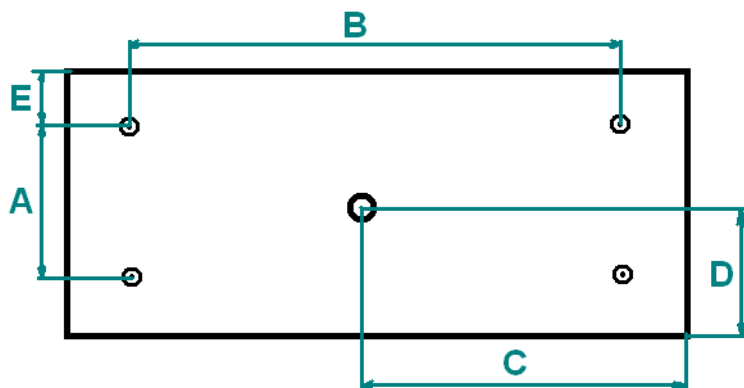

- fluorescent lamp mounting
 - put fluorescent lamp in the luminaire
 - rotate fluorescent lamp 90°
- place the louver
- close the luminaire with screwdriver

CAUTION! In the case of panel ceiling mounting, 3x28/54 version needs specially strengthened construction of ceiling at the place of mounting.

3. Important warnings:

The manufacturer cannot be considered liable for any damages deriving from improper, wrong and unreasonable use of the fitting.

Luminaries may be installed by qualified personnel only.

Any manipulation inside the luminaire when power supply is on causes the risk of electric shock.

Manufacturer is not responsible for any flaws caused by avoid using this manual.

Manufacturer reserves a right to change the construction of the product.

Do not assembly in places without air circulation.

To guarantee safety of luminaire functions, please assembly according to instruction.



The European Directive 2002/96/EC on waste electrical and electronic equipment, requires that electric and electronic devices must be disposed of in the normal household waste. The crossed out wheeled bin is reproduced in order to remember obligations towards separately collection. For correct disposal, please use authorized waste disposal facilities or returned to the distributor at the date a new lighting fitting is purchased. Lamps, if disposed together with the lighting fitting, shall not be broken up since they contain substances which are highly polluting for the environment. Unauthorized disposal of the foregoing waste material is punishable by law. More details of directive available at: <http://www.gios.gov.pl>

