

Installation manual Mikela/Milena



230V/50HZ LED

1. Dimensions

Power [W]	A	B	C	Weight(kg)
Milena 40	1135	504	400	3,5
Milena 60	1645	704	600	4,5
Mikela 50	1337	504	400	6

2. Installation

a) carefully take a luminaire out of the box and put it on a stable surface

b) power supply connection:

- put the feeding cable through the hole in the base of a suspension
- take suspension flap off
- connect the wire as shown on a cube

c) mounting of the suspension on a ceiling:

- luminaire's suspension should be mounted on the ceiling with two plugs with a spacing as shown on a picture (C)

d) pull the loose wire through the hole in a suspension flap and plug in into bipolar cube

e) drag suspension lines thorough the hole in a suspension flap as well as lines' fastenings and screw the lines' stoppers on

f) tighten controls in the sleeve assembly lines on the back of a luminaire's housing

g) screw universal suspension into the ceiling, unscrew external nut lightly, put the line in until obtaining optimum level of suspension and screw nut on. Putting line deeper cause luminaire lifting. In order to lower luminaire loosen nut

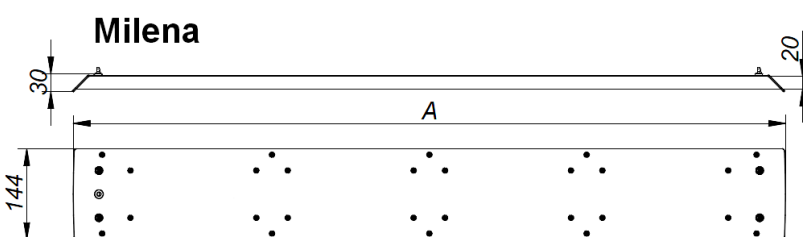
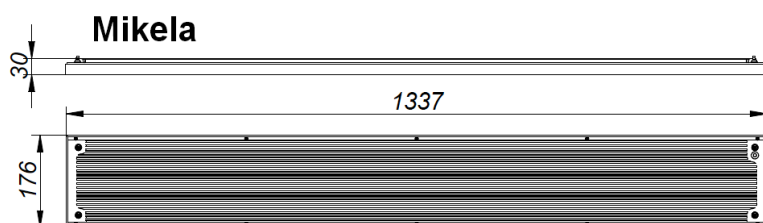

Zawieszenie

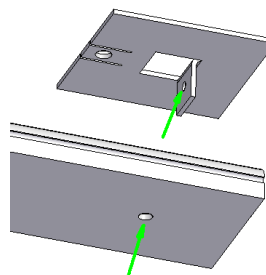
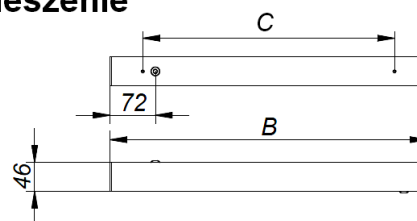

and press on - line will pull out.

3. Important warnings:

The manufacturer cannot be considered liable for any damages deriving from improper, wrong and unreasonable use of the fitting.

Luminaries may be installed by qualified personnel only.

Any manipulation inside the luminaire when power supply is on causes the risk of electric shock.

Manufacturer is not responsible for any flaws caused by avoid using this manual.

Manufacturer reserves a right to change the construction of the product.

Do not assembly in places without air circulation.

To guarantee safety of luminaire functions, please assembly according to instruction.



The European Directive 2002/96/EC on waste electrical and electronic equipment, requires that electric and electronic devices must be disposed of in the normal household waste. The crossed out wheeled bin is reproduced in order to remember obligations towards separately collection. For correct disposal, please use authorized waste disposal facilities or returned to the distributor at the date a new lighting fitting is purchased. Lamps, if disposed together with the lighting fitting, shall not be broken up since they contain substances which are highly polluting for the environment. Unauthorized disposal of the foregoing waste material is punishable by law. More details of directive available at: <http://www.gios.gov.pl>

