

HF-Pi 1 14/21/24/39 TL5 EII 220-240V

Kod produktu: 58422



Dane techniczne:

- Line Frequency **50/60 Hz**
- T-case maximum **75 (max) C**
- Full product code **913700624066**
- Full product name **HF-Pi 1 14/21/24/39 TL5 EII 220-240V**
- Order code **913700624066**
- Order product name **HF-Pi 1 14/21/24/39 TL5 EII 220-240V**
- Packing configuration **12**
- Pieces per pack **1**
- Bar code on outerbox - EAN3 **8711500914958**
- Bar code on pack - EAN1 **8711500914941**
- Packs per outerbox **12**
- Logistic code(s) - 12NC **913700624066**
- Net weight per piece **0.247 kg**
- Length A1 **360 mm**
- CE marking **Yes**
- Height C1 **22 mm**
- T-ambient **-25 (min), 50 (max) C**
- Width B1 **30 mm**
- Lifetime 90% surv.@Tcaselife **50000 hr**
- Fixing Hole Diameter D1 **4.2 mm**
- Fixing Hole Distance Length A2 **350 mm**
- Inrush current Peak **20 (max) A**
- Earth leakage current **0.5 (max) mA**
- Inrush current Width **0.35 ms**
- T-storage **-40 (min), 80 (max) C**
- Rated Lamptype **TL5**
- Line Voltage **220-240 V**
- Rated Ballast-Lamp Power **14-39**
- Rated Number of Lamps **1 piece**
- T-case life **75 C**
- Approval marks **ENEC / VDE-EMV**
- Automatic restart **Yes**
- Energy Efficiency Index **A2**
- Housing **L 360x30x22**
- Mains voltage safety (AC) **-10%/+10%**
- Mains voltage performance (AC) **-8%/+6%**
- Ballast Lumen Factor **1.00 -**
- Power losses gear **1.9-2.5 W**
- Crestfactor **1.7 (max) -**

- Max ballast on MCB(16A type B) **18 x**
- Cable-Cap outputwires mutual **70 pF**
- Hum and Noise level **Inaudible**
- Conn.type input terminals **Insert**
- Conn.type output terminals **Insert**
- Max. cable length Hot Wires **0.75 m**
- Striplength **8.0-9.0 mm**
- Wcs Input terminals **0.50-1.00 mm²**
- Wcs Output terminals **0.50-1.00 mm²**
- Bumps **IEC 68-2-29 Eb**
- EMI 9kHz .. 30 MHz **EN 55015**
- Vibrations **IEC 68-2-6 Fc**
- Application code **EII**
- Ignition Method **Warm Start**
- Ignition time **5.0 (max) s**
- Battery voltage running lamps **198-276**
- T-ignition **-25 (min), 50 (max) C**
- EMI 30 MHz .. 1000MHz **EN 55022 Class B**
- Performance Standard **IEC 60929**
- Safety Standard **IEC 61347-2-3**
- Environmental Standard **ISO 14001**
- Quality Standard **ISO 9000:2000**
- Harmonic current emissions **IEC 61000-3-2**
- EMC Immunity **IEC 61547**
- Humidity **EN 61347-2-3 clause 11**
- Emergency standard **IEC 60598-2-22**
- Temperature marking **110 [Yes]**
- Cable-Cap outputwires to earth **70 pF**
- Constant wattage deviation **-2%/+2%**
- Lamp Power on TL5 HO **24.3/37.5**
- Power Loss on TL5 HO **2.2/2.4**
- Rated Lamp Power on TL5 HO **24/39**
- System Power on TL5 HO **26.5/39.9**
- Lamp Power on TL5 HE **14.7/21.2**
- Rated Lamp Power on TL5 HE **14/21**
- System Power on TL5 HE **16.6/23.6**
- Power Loss on TL5 HE **1.9/2.4**

HF-Performer Intelligent for Master and ECO TL5 HE/HO, TL-D and PL-L lampsHF-Performer Intelligent features automatic recognition of the connected lamp and is independently able to adjust its operation parameters exactly to the respective lamp. This results in a substantial benefit, especially for T5 lamps, as it means TL5 HE and HO lamps of the same length can be interchanged. With a choice of seven ballasts, the customer is able to handle efficiently every possible combination of Master TL5 and Eco, TL-D, and PL-L lamps.

HF-Performer Intelligent for Master and ECO TL5 HE/HO, TL-D and PL-L lampsHF-Performer Intelligent features automatic recognition of the connected lamp and is independently able to adjust its operation parameters exactly to the respective lamp. This results in a substantial benefit, especially for T5 lamps, as it means TL5 HE and HO lamps of the same length can be interchanged. With a choice of seven ballasts, the customer is able to handle efficiently every possible combination of Master TL5 and Eco, TL-D, and PL-L lamps.

Features

Highest CELMA Energy Efficiency Index A2 BAT

Complies with CE, ENEC, EL, VDE-EMC, CCC marks of conformity

Average nominal service lifetime over 100,000 hours (at Ta 50 °C) with a failure rate ≤ 0.1 % per 1,000 hours

Optimized lamp preheating for a minimum of 50,000 On/Off switch operations without lamp replacement

Applications

Suitable for DC operation and emergency lighting installations; full compliance with requirements for emergency lighting according to EN 61347-2-3-annex J

Extended lamp life in frequent-switching applications, e.g. where occupancy sensors or motion detectors are used

For luminaires of protection class I and protection class II used in office buildings, hospitals, supermarkets, department stores, industrial premises and schools

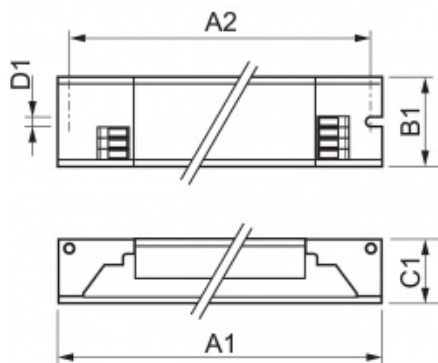

Bulb type	Lamp type	Lamp power	T _a = -40°C	T _a = -20°C	T _a = +20°C	Operating hours T _a range = -40°C
MR11 14.3 x 35.7 TL3 ED 220-240V	TL3 MR	14W				
	TL3 MR	21 W				
	TL3 HCD	26W				
	TL3 HCD	39W				
	TL3 MR ECO	15W				
	TL3 MR ECO	18W				
	TL3 HCD ECO	26W				
	TL3 HCD ECO	36W				
	TL3 D-Gemini	18W				
	TL3 D-Gemini	24W				
	RL-S	18W				
	RL-S	26W				
	RL-S	36W				
	RL-S	40W				
	TL3.E	22W				
	TL3.E	40W				